



OPERATING & ASSEMBLY INSTRUCTION

POWERLINK Series

A.APPLICATION INSTRUCTION

APPLICATION:

POWERLINK series is intended for use as an appliance coupler and interconnection coupler. It serves to supply power to an appliance and from an appliance to other equipment. To be installed by qualified person only.

Connector Combination & Keyways:

With the two non-inter changeable types of connectors (Type 1 and Type 2) it is impossible to produce a short circuit. Mating connectors (combination) are identified by mechanical keyways and by color.

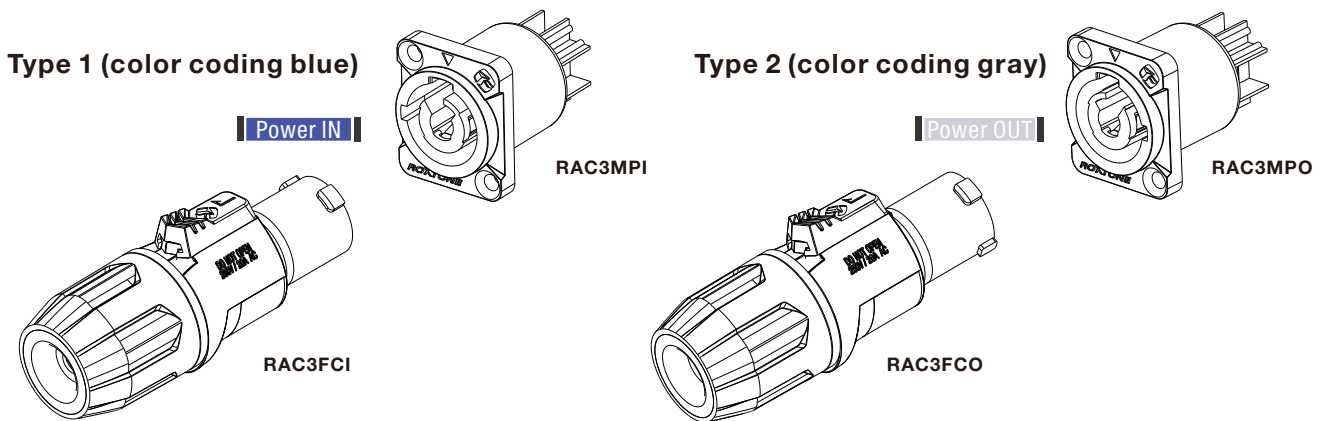

B.ASSEMBLY INSTRUCTION

(A) Insert cable into the bushing and housing.

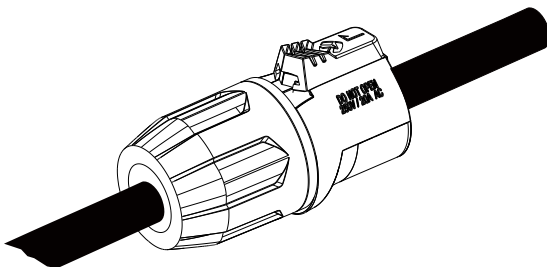

(B) Separate the housing from the bushing (cable remain in bushing)

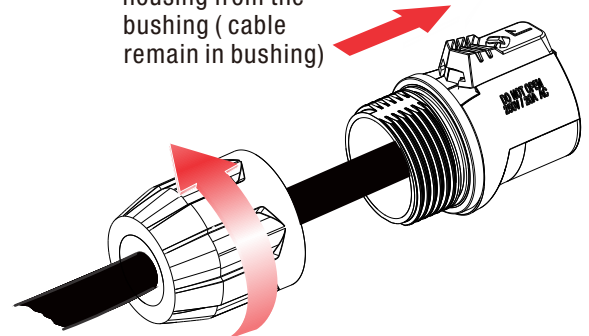

(C) Place the bushing ① and the clamp ② over the cable.

White clamp (a): 6.0 - 9.0 mm [0.236 - 0.354 "]
Black clamp (b): 9.0 - 12.0 mm [0.354 - 0.472 "]

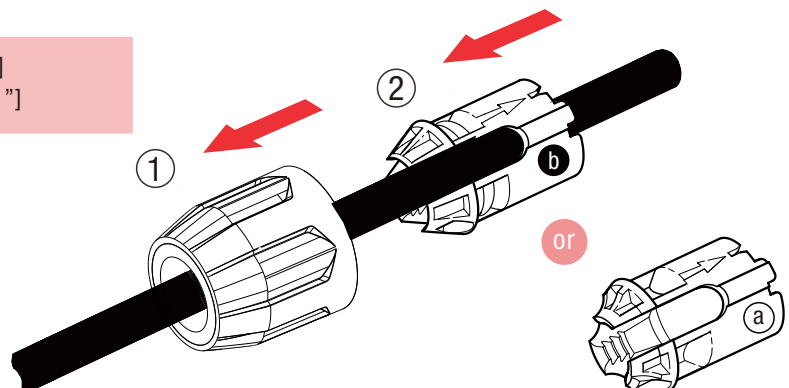

(D) Prepare the cable as shown.

Cable O.D.: 6.0 - 12.0 mm [0.236 - 0.472"] .
Max wire size : 2.5 mm² (AWG 14) .

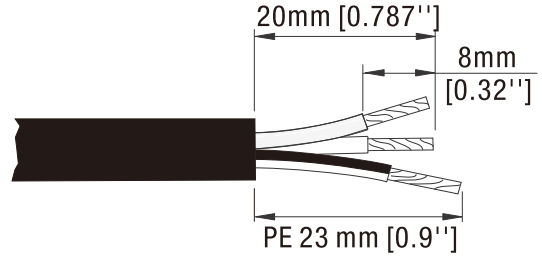

(E) Insert the wire into the terminals and fasten.

Max. Torque 0.5 Nm (0.37 1b-ft).

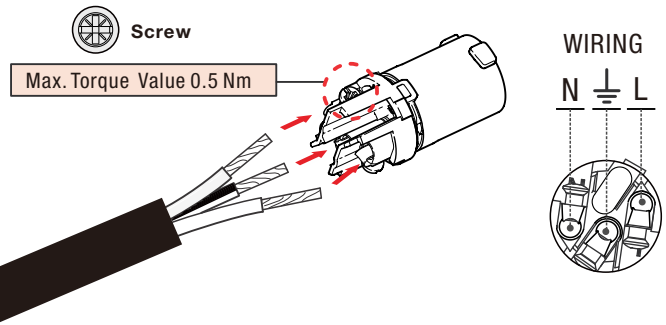

(F)

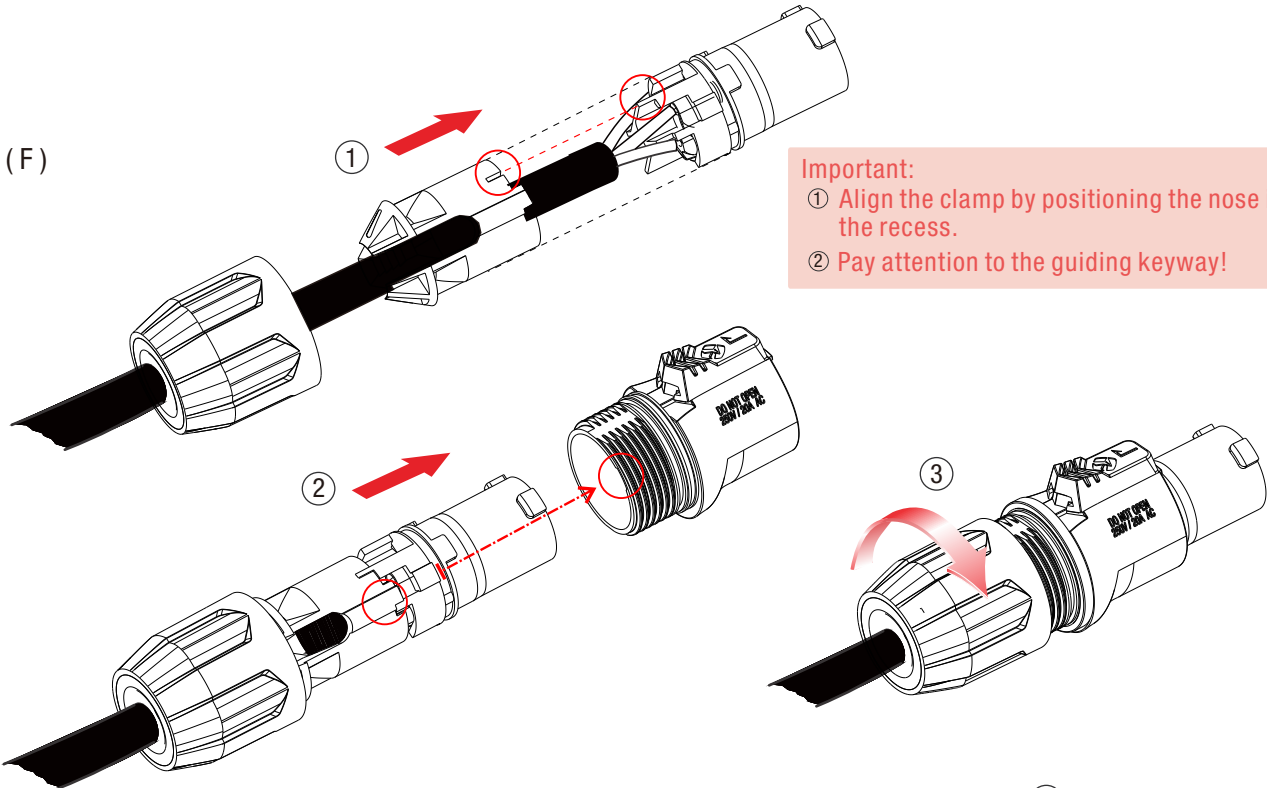

Important:
① Align the clamp by positioning the nose into the recess.
② Pay attention to the guiding keyway!

Slide the cable clamp ② bushing up the cable and tighten it ③.

CAUTION

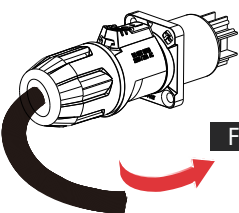

To ensure protection category, do not expose the connection to bending forces (e.g. do not attach loads to the cable, no free-dangling cable windings etc.).

SAFETY WARNING



For safety and certification reasons the connector must be replaced in case of any broken parts or excessive wear and tear.

FINISHED STATUE

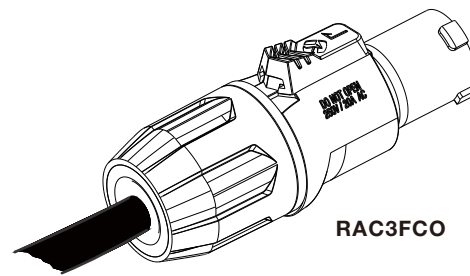
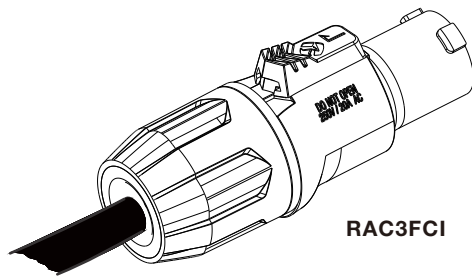

www.roxtone.com